

LPMS Melt System

熔胶单元

KÖNIG
康尼格

KH05

通过低压注塑设备控制
灵活搭载多种平台康尼格设备

Control by low pressure injection equipment
Flexible adapt with multiple platforms of KONIG equipment

DH05

自带熔胶控制系统
适配客户现有平台

With control system
Adapt to customer's existing equipment

一体成型 更优导热 CNC Making

- 全铝CNC一体成型，热能利用率比原来提高2倍；
- 特殊的加热结构使热熔胶加热更加均匀。
- Aluminum alloy CNC making, the heat conduction is twice high as before.
- Special heating structure makes heating more uniform.

恒压控制 出胶稳定 Constant Pressure Control

- 高可靠性齿轮泵，出胶量不低于8克/转。
- High reliability gear pump, injection rate is no less than 8g/rpm.

梯度温控 持续熔胶 Gradient Temperature Control

- 只将底部胶料熔化，添加新料无需等待熔胶；
- 持续出胶速率高达38克/分钟。
- Only melt the bottom material, continuously work when add new material. Sustainable flow rate is up to 38g/min.

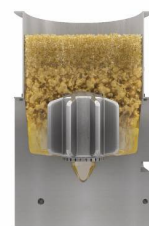
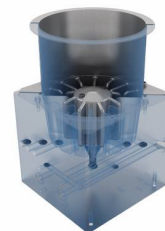

空气对流技术 保证持续工作 Air Convection Technology

- 胶缸覆盖特殊纤维保温层，锁住热能；结合创新的空气对流技术，保证电气系统正常工作温度。
- Melt system use special fiber insulation layer on cylinder, combine with air convection technology, to ensure working temperature.

抗碳化 易清理 Carbonization Resistance

- 四层铁氟龙烧结，防止粘缸，抗碳化效果优异；
- 胶缸使用寿命延长，同时余料极易清理。
- 4 time Teflon coating, avoid sticking cylinder, to make excellent carbonization resistance,
- Long service life, and the surplus material is easy to clean.

控制面板操作 二维码追溯 Two-dimensional code Product traceability

- 采用控制面板设置参数，操作方便；
- 零部件均有二维码，使用说明、使用周期可追溯
- Two-dimensional code, product traceability
- Easy to operate with a control system; use code to trace the instruction and using cycle.

LPMS Melt System

熔胶单元



Carbonization Resistance
Less Waiting Time Faster Start Work

有效防止碳化 更少等待时间 更快开展工作

机台尺寸重量 Machine Size	DH05-860×370×890mm(55kg) KH05-655×380×930 mm(53kg)
包装尺寸重量 Packing Size	DH05-1060×570×1090 mm(60kg) KH05-855×580×1130 mm(58kg)
注胶管型号与数量 Heated Hose	KJ 16 / KJ 22×1PC/2PC
输入电压 Electricity	220VAC / 1Phase / 50 or 60Hz
温控分区 Temperature Control Zones	3
最高设定温度 Temperature	up to 250°C
最大功率 Max. Power	3.5Kw
最低工作气压 Min. Air Pressure	0.5Mpa

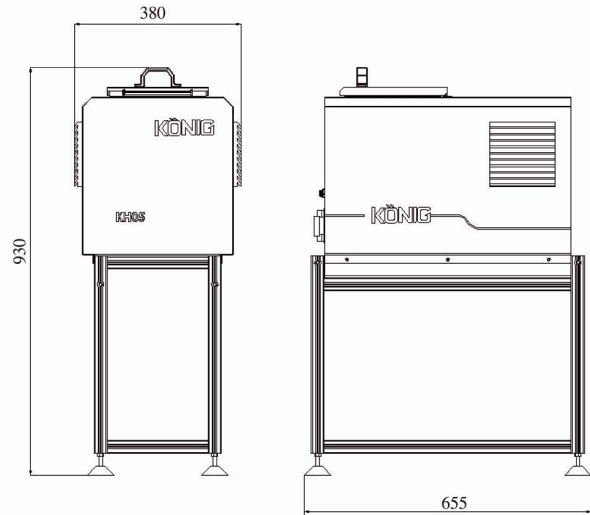

输胶管 Hose

KJ22输胶管，耐高温，温控精准，进胶口、出胶口温度差±2℃。

KJ22 hose, heat resistant, temperature precisely controlled, temperature difference for the inlet and outlet rubber mouth is in ±2°C.



注胶枪 Injection Nozzle

KG40注胶枪，不渗胶，高可靠性。精密的压力控制，使用周期可达120万次。

KG40 injection nozzle, non-penetrating adhesive, high reliability. The cycle time up to 1,200 thousand with precision pressure control.



齿轮泵 Gear Pump

KP25齿轮泵，结构紧凑，优异的设计带来精密的计量和稳定的出胶，出胶量不低于8克/转

KP25 gear pump, compact structure, excellent design brings precision metering and stable injection, injection rate is no less than 8 g/rpm.

可选容量 Optional Capacity	<input type="checkbox"/> 5L	<input type="checkbox"/> 10L	<input type="checkbox"/> 15L
可选控制方式 Optional Control Mode	<input type="checkbox"/> DH自带熔胶控制系统 DH with control system		<input type="checkbox"/> KH无控制系统 KH no control system

苏州康尼格电子科技股份有限公司 Suzhou KONIG Electronic Technology Co., Ltd

江苏省·苏州市·常熟辛庄镇长盛路33号 No.33 Changsheng Road, Xinzhuang, Changshu, Suzhou

T +86-512-5247 9018 | F +86-512-5247 9098 | E info@konig.hk

