

# KM1600

**KÖNIG**  
康尼格

## Micro Injection Molding Machine

微型精密注塑设备

自由应用各种热塑性材料、高性能材料  
是客户开发微精密注塑产品及测试新材料的理想之选

Free for all kinds of thermoplastic materials, high-performance materials, is an ideal choice for customers to develop micro component projects and testing new materials.

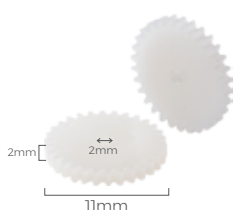

### COMPACT STRUCTURE

结构紧凑

创新的扁平螺杆实现设备小型化，占地面积约0.4m<sup>2</sup>  
Innovative flat screw realizes miniaturization of equipment, covering area about 0.4 m<sup>2</sup>

### PRECISION INJECTION

注塑精密

专注生产5g以下橡塑制品，微米级计量，高重复精度  
Specialized in 5g micro products, micron measurement with high repeatability

### MATERIAL SAVING

极少余料

塑化单元约7g余料，节约材料成本，换料方便易于清理  
Plasticizing unit just remain about 7g materials, saving material, also easy to clean up

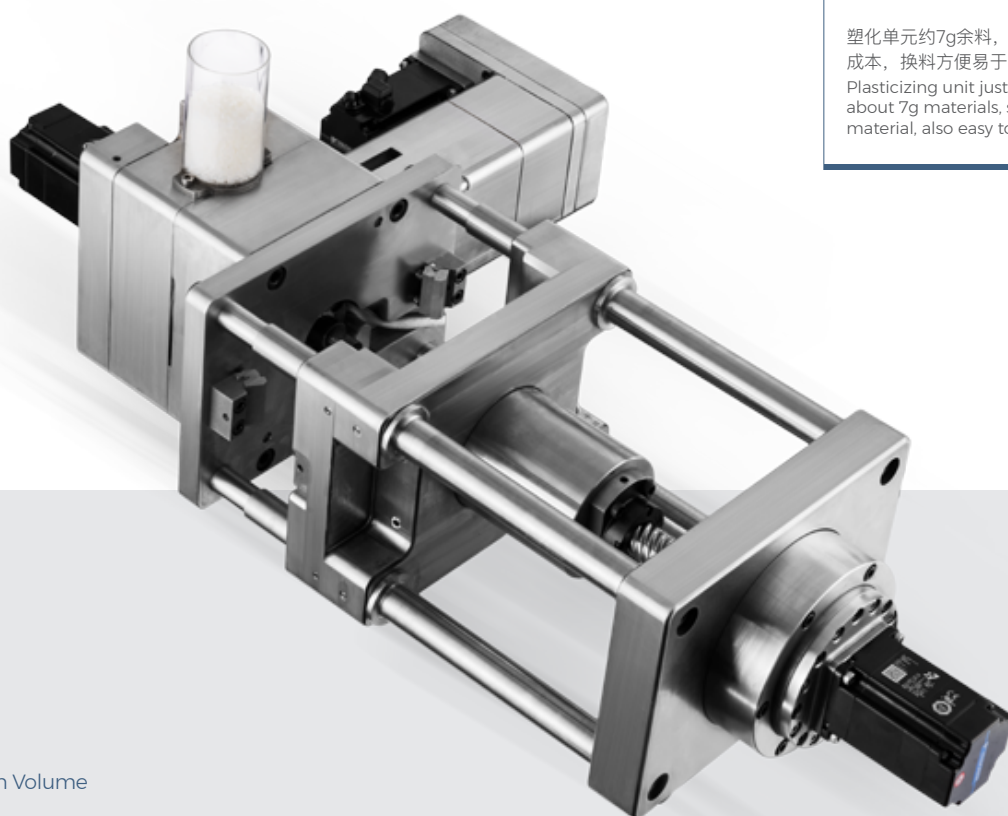

∅ 80mm

扁平螺杆直径  
Flat Screw

0.01cc

最小注射量  
Min. Injection Volume

3cc

最大注射量  
Max. Injection Volume

# KM1600

**KÖNIG**  
康尼格

Precision and  
Repeatability with easy operate  
这一切，让您的产品精密可靠  
让您的工作变得简单

扁平螺杆直径 Screw Diameter	φ80 mm
柱塞直径 Plunger Diameter	φ10 / φ12 / φ14 mm
螺杆转速 Screw Speed	30 rpm/min
注射行程 Screw Stroke	Max 40 mm
注射压力 Injection Pressure	0-3940 / 0-2742 / 0-2060 bar
注射速度 Injection Speed	12.5 mm/sec
最大射出量 Max Injection Volume	3 / 4.5 / 5 CC
合模力 Mold Clamping force	3 ton
合模速度 Mold Clamping Speed	12.6 mm/sec
开闭模行程 Mold Clamping Stroke	100 mm
架模尺寸 Die Size	160×130×96 mm
顶出行程 Ejector Stroke	10 mm
热嘴型号 Hot Runner	No.1866
料斗容量 Hopper Capacity	0.2 liter
伺服马达 Servo Motor	400 w×3 pc
电热功率 Power Consumption(excl.heat)	1300 w
电源规格 Electrical Source	AC220 V
机器尺寸 Machine Size (HxDxW)	840×435×300 mm
机器重量 Machine Weight	98 kg

## 创新的塑化单元 Innovative plasticizing units

自由应用各种热塑性材料及高性能材料，塑化温度可达420℃。材料即熔即用，防止碳化并保证材料性能。

Suitable for all kinds of thermoplastic materials and high performance materials, plasticizing temperature is up to 420 C. Material is directly using after melting, ensure material properties without carbonization.

## 高精度的注射单元 Precision Injection Unit

伺服电机与减速机配合，实现高精度的微量射出及高重复能力。

Servo motor with worm gear reducer to achieve precision micro-injection and good repeatability

## 特殊的流道一体技术 Built-in Runner System

冷/热流道可选，节约模具开发成本。流道两段控温，优化对材料温度的控制。

The cold/hot runner can be selected, saving mold cost. Temperature can be controlled by two sections of runner, optimize material temperature.

## 稳定可靠的控制器 Reliable Control Unit

触摸屏操作，采用MECHATROLINK通讯协定，生产数据模具资料可储存。

Use MECHATROLINK communication protocol with touch screen, production data mold data can be stored.

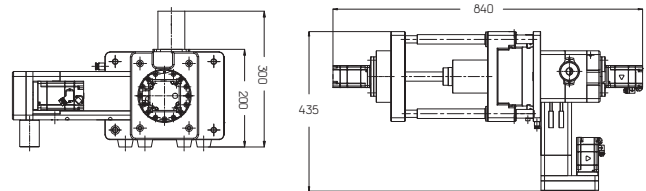

## 应用领域 APPLICATIONS

高精密微小产品 | 微结构产品 | 粉末注塑 | 洁净室生产

High precision micro products, microstructures, powder injection molding, cleanroom production

### 可选设备 Accessories

工作台

Workbench

干燥机

Drier

冷水机

Chiller

模温机

De-humidifier

自动上料机

Automatic feeder

苏州康尼格电子科技股份有限公司 Suzhou KONIG Electronic Technology Co., Ltd

江苏省·苏州市·常熟辛庄镇长盛路33号 No.33 Changsheng Road, Xinzhuang, Changshu, Suzhou

T +86-512-5247 9018 | F +86-512-5247 9098 | E info@konig.hk

